

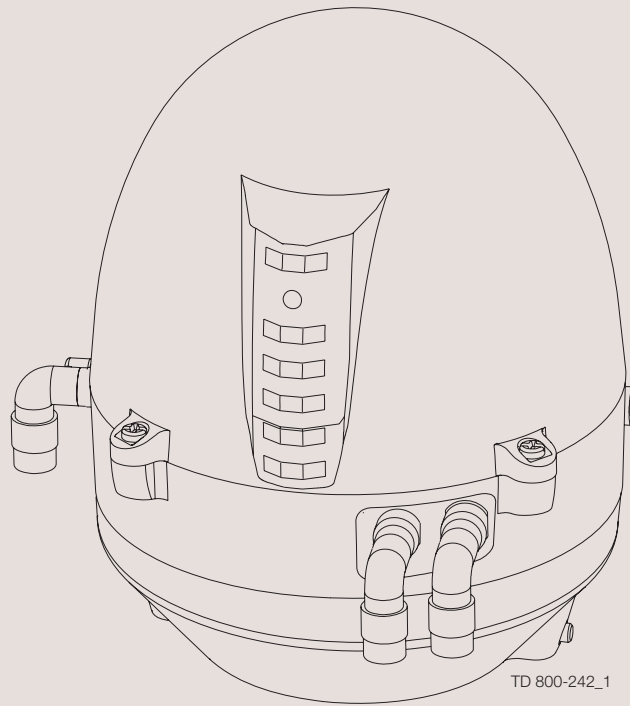

Instruction Manual

ThinkTop® AS-Interface v.2.1 (31 nodes) & v.3.0 (62 nodes) 29.5 - 31.6 VDC



Patented Sensor System
Registered Design
Registered Trademark

ESE00356-EN10 2011-07

Original manual

The information herein is correct at the time of issue but may be subject to change without prior notice

| | |
|--|-----------|
| 1. EC Declaration of Conformity | 4 |
| 2. Safety | 5 |
| 2.1. Important information | 5 |
| 2.2. Warning signs | 5 |
| 2.3. Safety precautions | 6 |
| 3. General information | 7 |
| 3.1. AS-Interface in general | 7 |
| 4. Technical specifications | 8 |
| 4.1. ThinkTop, AS-Interface | 8 |
| 5. Installation | 14 |
| 5.1. Installation on air actuators | 14 |
| 5.2. Installation on Series 700 valves | 17 |
| 5.3. Air connections | 18 |
| 5.4. Electrical connection, internal | 19 |
| 6. Setup diagram | 20 |
| 6.1. ThinkTop setup utilising IR keypad | 20 |
| 6.2. ThinkTop setup utilising local 'I' and 'II' keys | 22 |
| 6.3. ThinkTop quick setup guide | 24 |
| 7. Fault finding | 26 |
| 7.1. Fault finding and LEDs | 26 |
| 8. Maintenance | 28 |
| 8.1. Dismantling of ThinkTop | 28 |
| 8.2. Assembly of ThinkTop | 30 |
| 8.3. Dismantling and assembly of Series 700 valves | 32 |
| 9. Parts list and Service Kits | 33 |
| 9.1. Drawings for ThinkTop AS-Interface | 33 |
| 9.2. ThinkTop AS-Interface | 34 |
| 9.3. Drawings for ThinkTop AS-Interface for Series 700 | 37 |
| 9.4. ThinkTop AS-Interface for Series 700 | 38 |

1 EC Declaration of Conformity

The designating company

Alfa Laval

Company Name

Albuen 31, DK-6000 Kolding, Denmark

Address

+45 79 32 22 00

Phone No.

hereby declare that

Top Unit for Valve Control & Indication

Denomination

ThinkTop AS-Interface

Type

Year

is in conformity with the following directives with amendments:

- Low Voltage Directive (LVD) 2006/95/EF
- EMC Directive 2004/108/EF
- ROHS Directive 2002/95/EEC

Manager, Product Centres, Compact
Heat Exchangers & Fluid Handling

Title

Bjarne Søndergaard

Name

Alfa Laval Kolding
Company

Signature



Designation



*Unsafe practices and other important information are emphasized in this manual.
Warnings are emphasized by means of special signs. All warnings in the manual are summarized on this page.
Pay special attention to the instructions below so that severe personal injury or damage to the top unit are avoided.*

2.1 Important information

Always read the manual before using the top unit!

WARNING

Indicates that special procedures must be followed to avoid serious personal injury.

CAUTION

Indicates that special procedures must be followed to avoid damage to the ThinkTop.

NOTE

Indicates important information to simplify or clarify procedures.

2.2 Warning signs

General warning:



Dangerous electrical voltage:



Caustic agents:



2 Safety

Unsafe practices and other important information are emphasized in this manual.

Warnings are emphasized by means of special signs. All warnings in the manual are summarized on this page.

Pay special attention to the instructions below so that severe personal injury or damage to the top unit are avoided.

2.3 Safety precautions

Installation

Always read the technical data thoroughly.



Never install the ThinkTop before valve or relay is in a safe position.



If welding close to the ThinkTop: **Always** earth close to the welding area.



Disconnect the ThinkTop.



Always have the ThinkTop electrically connected by authorized personnel.



Maintenance

Always read the technical data thoroughly.



Always fit the seals between valve and ThinkTop correctly.



Never service the ThinkTop before valve or relay is in a safe position.



Never service the ThinkTop with valve/actuator under pressure.



Never clean the ThinkTop with high pressure cleaning equipment.



Never use cleaning agents when cleaning the ThinkTop. Check with cleaning agent supplier.



3.1 AS-Interface in general

The ThinkTop is designed to ensure optimum valve control in conjunction with Alfa Laval sanitary valves and it is compatible with all major PLC systems (Programmable Logic Controller with AS-interface).

The ThinkTop can be equipped with 0-3 solenoid valves. The solenoids are electrically controlled by the AS-Interface and when activated the compressed air is activating the air actuator. All solenoids have build-in throttle function on both air inlet and outlet which means that it is possible to control the opening and closing time of the air actuator. The solenoids are also equipped with a manual hold override.

Visual LED lights are constantly indicating the status of the unit: Valve positions, solenoid energized, setup and local fault indication etc.

The ThinkTop is characterized by a simple and modular design. It is exchangeable and is prepared for upgrading.

4 Technical specifications

4.1 ThinkTop, AS-Interface

“No Touch” sensor system

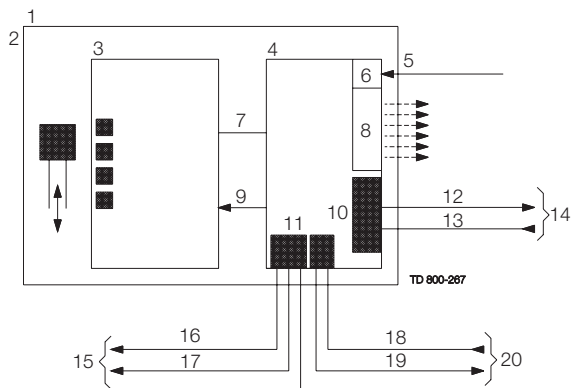

- | | |
|------------------------|------------------------------|
| 1. Sensor unit | 11. Terminals |
| 2. PLC, feedback | 12. ASI + |
| 3. Sensor board | 13. ASI - |
| 4. PLC interface board | 14. Bus Connection |
| 5. IR Remote control | 15. Internal connections |
| 6. IR Rx | 16. Solenoid signals (DC) |
| 7. Serial link | 17. Solenoid common |
| 8. LEDs | 18. External seat-lift (PNP) |
| 9. +5 V | 19. Supply sensors |
| 10. Terminals | 20. External connections |

Type: Alfa Laval “No Touch” System. For wire connections: See 5.4 Electrical connection, internal“.

Features

- Tolerance programmes.
- Self adjustment programme (SRC/ARC valves only).
- Built-in maintenance monitor.
- Setup by internal push buttons or remote control (IR Keypad).
- Setup and local fault supervision.
- Setup saved at power shutdown.
- Visual LED Indicator lights.

Sensor System

Unique “No Touch” sensor system without any mechanical sensor adjustments. A magnet (indication pin) is mounted on the valve stem and the magnetic field (axial) is detected by sensor chips inside the sensor board. The measuring angle from each chip is used to locate the current position of the valve stem with an accuracy of ± 0.1 mm. Note that the distance to the indication pin can be $5 \text{ mm} \pm 3 \text{ mm}$.

Feedback signals

The sensor system can be used for 3 feedback signals + 1 status signal = 4 feedback signals. (One of the feedback signals can be used for two external sensors if necessary).

The status signal is used for detection of the following conditions:

- A set-up is in progress.
- Internal error.
- Maintenance is required (based on time and/or the self adjustment programme).

Tolerance programme

Individual programme according to valve types.

- | | |
|---------|--|
| Type 0: | Bypass valve type / keep present valve type. |
| Type 1: | SRC/ARC and Series 700 valves, only when self adjustment is enabled - Not recommended. |
| Type 2: | LKB (LKLA-T). |
| Type 3: | Unique Mixproof, SMP-SC Spillage-Free, and SRC-PV. |
| Type 4: | SMP-SC, SMP-TO, SMP-BC, SMP-BCA, SBV, SRC, ARC, Unique SSV, Unique SSV Aseptic, Unique-TO and Series 700 valves. |
| Type 5: | All Parameters Set To Default (also valid for MH valve and SMP-EC (seat-lift indication not possible for SMP-EC)). |

Preset and reset values: Tolerance programme No./Type 5 (± 5 mm) and all functions are disabled.

Note! Important to select the right tolerance programme in order to ensure optimum controlled closeness of valves.

Self Adjustment (SRC/ARC valves only)

The self adjustment feature is an exceptional aspect of the ThinkTop design. A programme can be activated to allow an adjustment of the tolerance band if the seals in the valve are being compressed or are worn. When the tolerance band of the unit has been adjusted 0.3 mm, an alert warning will appear in the form of a status signal and a flashing maintenance LED. After 0.5 mm adjustment an alarm warning appears: Loss of feedback signal, status signal and steady maintenance light indicating a replacement of the seal.

Built-in Maintenance Monitor

The unit can be preset to indicate when the time for maintenance of the valve has been reached. A status signal and flashing maintenance LED can be programmed to return after 3, 6, 9 or 12 months or more.

Technical specifications

Sensor system

Sensor accuracy: ± 0.1 mm.
Distance to indication pin: 5 ± 3 mm.
Stroke length: 0.1 - 80 mm.

Electrical connection:

Direct main cable gland entry (hard wired) PG11 ($\varnothing 4 - \varnothing 10$ mm).

Direct external/sensor cable gland entry PG7 ($\varnothing 3 - \varnothing 6.5$ mm) option, external sensor.

Terminals

The terminal row of the sensor unit is equipped with screw terminals for both internal as well as external cables and wires. The terminals are suitable for wires up to 0.75 mm² (AWG 19).

Power Supply

The power supply to the complete unit is taken from the AS-Interface loop. The unit is reverse polarity protected.

Supply voltage: 29.5 - 31.6 VDC

Normal current consumption sensor

board: 45 mA (excluding current for the solenoids and the external sensor).

Max. current consumption sensor

board: 120 mA (If external devices e.g. solenoids and switches are connected to the sensor board, a higher current consumption than 120 mA may occur and this will damage the sensor boards).

The fulfilling of the UL requirements in UL508 requires that the unit is supplied by an isolating source complying with the requirements for class 2 power units (UL1310) or class 2 and 3 transformers (UL1585).

Feedback signals

Signals transmitted through the AS-Interface BUS to the AS-Interface master PLC.

4 Technical specifications

External sensors

The external sensors are used for seat-lift supervision when seat-lift can not be internally detected. The sensors get their supply voltage from the terminal row. The output signals from the sensors are connected to two inputs on the terminal row on the internal sensor unit. If the actual setup is set for internal seat-lift, the corresponding external signal is not used, otherwise the external signal logically controls the corresponding feedback to the PLC (Programmable Logic Controller).

Note! If using external sensor, the sensor must be active/activated when performing a setup routine of the control head.

Supply voltage: As specified for the AS-Interface (typical 30VDC)
Supply current: Max. 15 mA per sensor.
Type of sensor: VDC, only 3-wire sensor, PNP.
Cable length: Max. 3 m.

Slave profile v.2.1

Default slave address: 0

IO code: 7 (4 bit bi-directional)
ID code: F (slave without profile)
ID1 code: F
ID2 code: F
Slave profile = S-7.F.F.F

No. of slaves:

AS-Interface specification 2.1 for max. 31 ThinkTop units on a single master/gateway

Slave profile v.3.0

Default slave address: 0

IO code: 7 (4 bit bi-directional)
ID code: A
ID1 code: 7
ID2 code: 7
Slave profile = S-7.A.7.7

No. of slaves:

AS-Interface specification 3.0 for max. 62 ThinkTop units on a single master/gateway

AS-Interface bits assignment:

For the AS-Interface version with 31 and 62 nodes, the following bit assignment will be used:

DI 0 Feedback # 1 De-Energised Position (closed position)
DI 1 Feedback # 2 Energised Position (open position)
DI 2 Feedback # 3-4 SeatLift 1 or 2 position
DI 3 Feedback # 5 Status

DO 0 Not connected
DO 1 Solenoid valve 1
DO 2 Solenoid valve 2
DO 3 Solenoid valve 3

ThinkTop Visual Indications

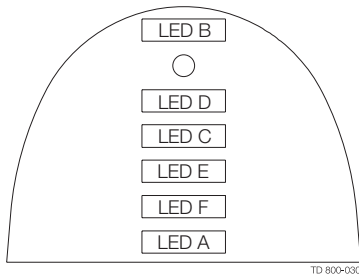

LED Indications

| | |
|-------|------------------------------|
| LED B | “Open valve” (Yellow) |
| O | IR-Receiver |
| LED D | “Setup/Internal fault” (Red) |
| LED C | “Seat-lift 1/2” (Yellow) |
| LED E | “Solenoid valves” (Green) |
| LED F | “Maintenance” (Orange) |
| LED A | “Closed valve” (Yellow) |

Note: If the programmer wishes to detect a physical closed valve position in an “Open Valve” sensor position, then there is no longer any consistence between the sensor valve detection position and the visual indications of the ThinkTop.

Status signal (feedback # 5) Input bit 3:

The status signal is used for four purposes:

To indicate that the set-up is ongoing (LED D)

To indicate an error condition (LED D) (flashing = software error), (steady = hardware error)

To indicate that the time for maintenance has been reached (LED F)

To indicate if there is a conflict in the self adjustment programme (LED F)

Technical specifications solenoid valves

Solenoid valve signals

Signals transmitted through the AS-Interface BUS to the AS-Interface master PLC.

Internal connections

Terminals for wire connection of the solenoids mounted internally in the control head. The number of solenoids actually mounted in the control head could be 0 - 3. The signals are taken directly from the terminal row.

4 Technical specifications

| Technical specifications | |
|---|---|
| Up to 3 solenoid valves in each unit. | |
| Type | 3/2 or 5/2 valve (only possible with one 5/2 valve). |
| Air supply | 300-900 kPa (3-9 bar). |
| Filtered air, max. particles or dirt | 5 μ 5-5 mg/m ³ . |
| Max. flow | 180 l/min. |
| Max. oil content | 1 mg/m ³ . |
| Max. water content | 0.88 g/m ³ -20 °C compressed air. |
| Throughput | ø2.5 mm. |
| Air restriction (throttle function) air inlet/outlet. | Yes. |
| Manual hold override. | Yes. |
| External air tube connection | ø6 mm or 1/4" (specify when ordering). |
| Silencer/filter | Connection possible via ø6 mm or 1/4". (Filter recommended in tropical regions). |
| Nominal voltage | 24 VDC. |
| Nominal power | 1.0 W. |
| Internal connections (solenoids) | |
| The solenoid drivers can reduce the solenoid power by PWM after the activation time. The PWM function is enabled by a jumper (12, 13). The number of solenoids actually mounted in the Control head could be 0 - 3. | |
| Nominal voltage | 24 VDC. |
| Nominal power | 1.0 W. |
| Output voltage | Must match the selected type of ThinkTop. |
| Load current | Max. 100 mA per solenoid. Max. current from any number of energized output stages is 200 mA. |
| Voltage drop | Max. 3 V at 50 mA. |
| Activation time | 60 ± 10 ms (time with full power if PWM is enabled). |
| PWM duty cycle | 40% (after activation time if PWM is enabled). |
| PWM frequency | 2 - 5 kHz. |
| Materials | |
| Plastic parts | Nylon PA12. |
| Steel parts | Stainless steel AISI 304 and 316. |
| Seals | Nitrile (NBR), EPDM rubber for SMP-EC activator stem. |
| Gore vent. membrane | PBT plastic. |

Micro environment demand specifications

| | | |
|-------------------------|---|----------------------------|
| Temperature | | |
| Working: | -20°C to +85°C | IEC 68-2-1/2 |
| Storage: | -40°C to +85°C | IEC 68-2-1/2 |
| Temperature change: | -25°C to +70°C | IEC 68-2-14 |
| Vibration | | |
| | 10-55 Hz, 0.7 mm | IEC 68-2-6 |
| | 55-500 Hz, 10g | |
| | 3 x 30 min, 1 octave/min | |
| Drop test | | IEC 68-2-32 |
| Humidity | | |
| Constant humidity: | +40°C, 21 days, 93% R.H. | IEC 68-2-3 |
| Cyclic humidity: | +25°C/+55°C | |
| | 12 cycles | IEC 68-2-30 |
| (working) | 93% R.H. | |
| Protection class | | IEC 529 |
| Input treshold | | |
| Voltage/current: | Type 1 input requirements | EN 61131-2 |
| EMC Directive | | EN 61000-6-3, EN 61000-6-2 |
| AS-Interface | | EN50295 |
| | Version 2.1*) | |
| | Version 3.0 **) | |
| UL Approval | | UL 508-E203255 |
| | 8-30 VAC/VDC, Class 2 input, 45 mA max. output | |

*) Max. 31 ThinkTop units on a single master/gateway. **) Max. 62 ThinkTop units on a single master/gateway.

5 Installation

5.1 Installation on air actuators

Step 1



Always read the technical data thoroughly.



Always have the ThinkTop electrically connected by authorized personnel.

Step 2

1. Fit the air fittings on actuator if not mounted.
2. Fit the activator stem (magnet) and tighten **carefully** with a spanner.

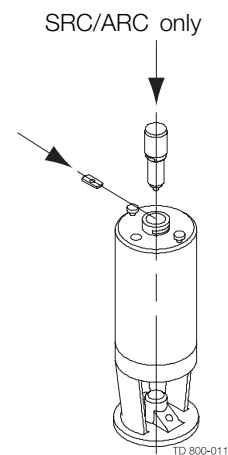

Step 3

1. Place the ThinkTop on top of the actuator.
2. Make sure X-ring is mounted.

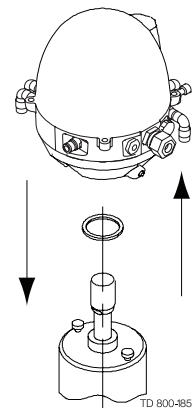

Step 4

1. Ensure that the unit is correctly mounted by **pressing** down on top of the ThinkTop.
2. Tighten the two Allen screws **carefully** (1.50 Nm).
3. Turn the actuator to have LEDs in a front view.

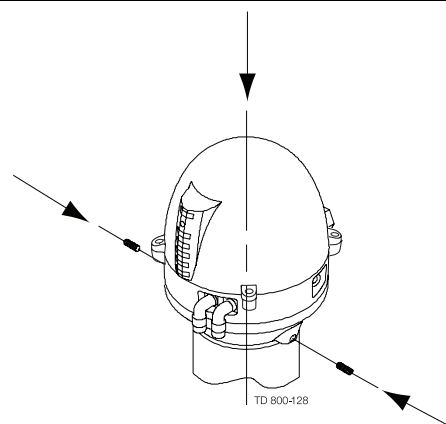

Step 5

Fit the $\varnothing 6$ mm (1/4") air tubes to ThinkTop.
(see drawing "Air connections" page 18).

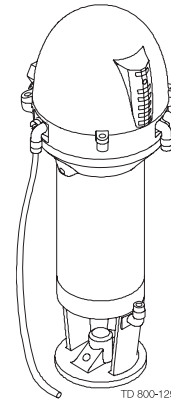

Step 6

Fit the air tubes to the actuator
(see drawing "Air connections" page 18).

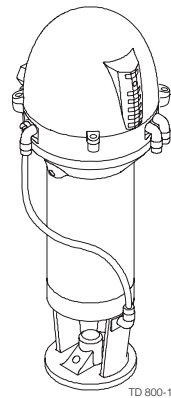

Step 7

Ungtighten the four screws and pull off cover of ThinkTop.

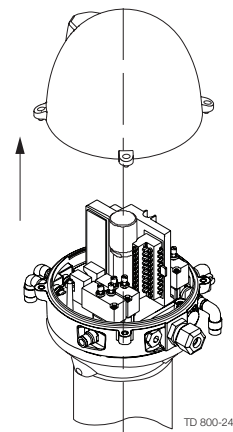

Step 8

1. Install cable (if not present) through the cable gland.
2. Connect the ThinkTop electrically
(see page 5.4 Electrical connection, internal).

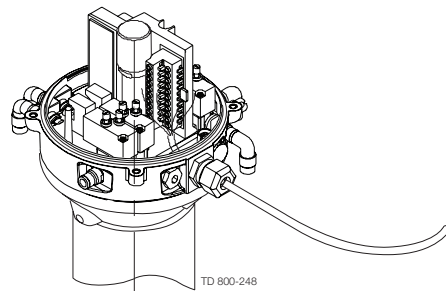

5 Installation

Step 9

Make sure the cable gland is completely tightened.

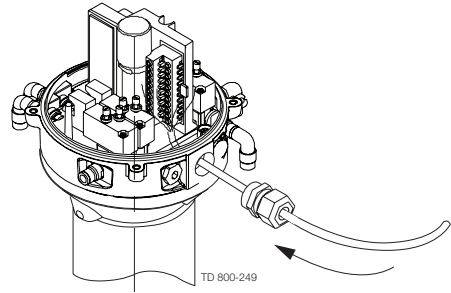

Step 10

Set up the ThinkTop (see chapter 6 Setup diagram).

NOTE!

The unit can be set up with the cover installed by using the IR keypad. To energize the valve, use a separate air tube or be in radio contact with the control room.

5.2 Installation on Series 700 valves

Step 1

1. Remove the cover by loosening the four cover screws.
2. Separate the adapter from the base by loosening the three recess screws on top of the base.

Installation on air actuators:

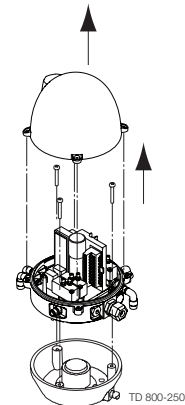

Step 2

1. Fit air fittings on actuator.
2. Position packing retainer in recess on actuator top.
3. Fit counter nut and indication pin (magnet) on actuator rod. Engage approx. 1/4" thread. Tighten counter nut and indicator with two wrenches.

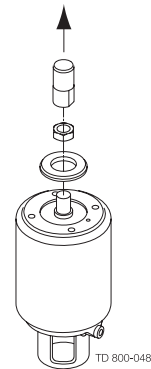

Step 3

1. Place the two O-rings in the grooves in the bottom of the adapter. Then place the adapter on the actuator top. The small O-ring must be positioned over the air hole on the actuator.
2. Fasten the adapter with the four 5/16" Allen screws.

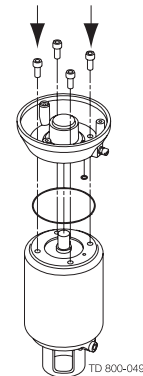

Step 4

Mount the base on the adapter in the position needed (can be rotated 120° in both directions). Note that one of the screw towers on the adapter has a guide recess (see * on drawing).

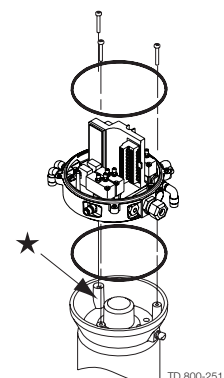

5 Installation

5.3 Air connections

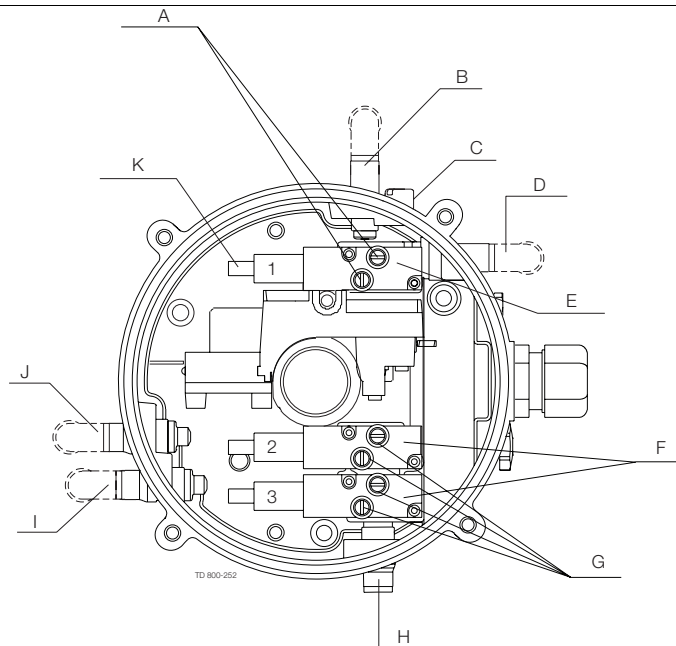

- A. Air restriction (throttle function) air inlet/outlet
 - B. Air out 1A
 - C. Air exhaust
 - D. Air out 1B (5/2 port solenoid valve only)
 - E. Solenoid 3/2 or 5/2
 - F. 3/2 Solenoid valves only
 - G. Air restriction (throttle function) air inlet/outlet
 - H. Air in
 - I. Air out 3
 - J. Air out 2
 - K. Manual hold override
-

5.4 Electrical connection, internal

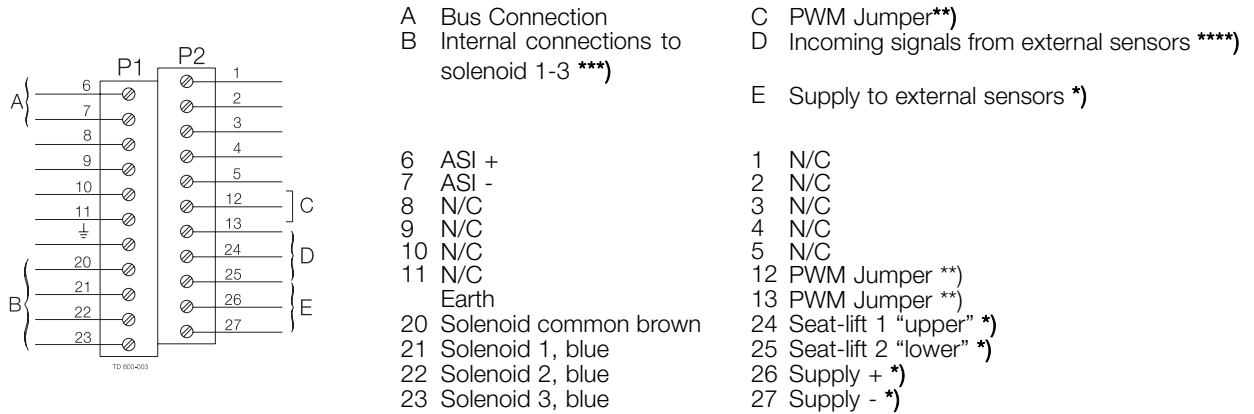

Table 1. Note!

- *) Terminals 24, 25, 26 and 27 can be used for external seat lift sensors as well as for any digital input. Always use an external PNP sensor. Two external signals can be connected, they are associated with feedback signal 3 (seat lift 1) and 4 (seat lift 2). External sensor must always be a 8-30 VDC PNP 3 wire sensor. Connect (-) common on terminal 27, and (+) common on terminal 26. The signals from the external sensors are associated as follows: sensor signal on terminal 24 (seat lift 1) associated with feedback 3 (seat lift 1), and sensor signal on terminal 25 (seat lift 2) associated with feedback 4 (seat lift 2).
- ***) Jumper present = PWM. See section 3.1.3 "Technical specifications solenoid valves".
- ****) Internal connections: Terminals for connection for the solenoids mounted internally in the control head. The number of solenoids actually mounted in the control head could be 0 - 3. The signals are taken directly from the terminal row.
- *****) If using external sensor, the sensor must be active/activated when performing a set-up routine of the control head.

6 Setup diagram

6.1 ThinkTop setup utilising IR keypad

General

Flashing LED means no value set. Steady LED means value set as shown

Default: Step 2, Factory set tolerance band +/- 5mm
Step 3-8, disabled

D LED: Active during set-up: Flashing in step 1
Steady in all other steps

Or during operations, error condition: Steady showing hardware fault, indication pin out of range
Flashing showing software fault







Timeout: A 60 sec. timeout is started as soon as any button(s) are released
On timeout the setup is exited with no changes saved

IR Keypad: Remote distance 0-300 mm to ThinkTop

Symbols



 Push key on IR keypad with the same number

Simple representation of LED indication:

| | | | |
|-------------|---|---|--------------|
| Yellow | B |  | |
| IR-Receiver | |  | |
| Red | D |  | Steady LED |
| Yellow | C |  | |
| Green | E |  | |
| Orange | F |  | |
| Yellow | A |  | Flashing LED |



General commands in each step (except step 1):

- | | | |
|---|-----------------------|---|
|  | Next step / skip step | (In step 3-6 the program automatically moves to the next step when a position is stored) |
|  | Clear / disable step | (In step 2 this resets the unit and set the step 2-8 to default) (The command is accepted when all unit LED's flash briefly) |

**It is recommended to reset the unit before
performing a setup
Always check for correct signals after the setup**

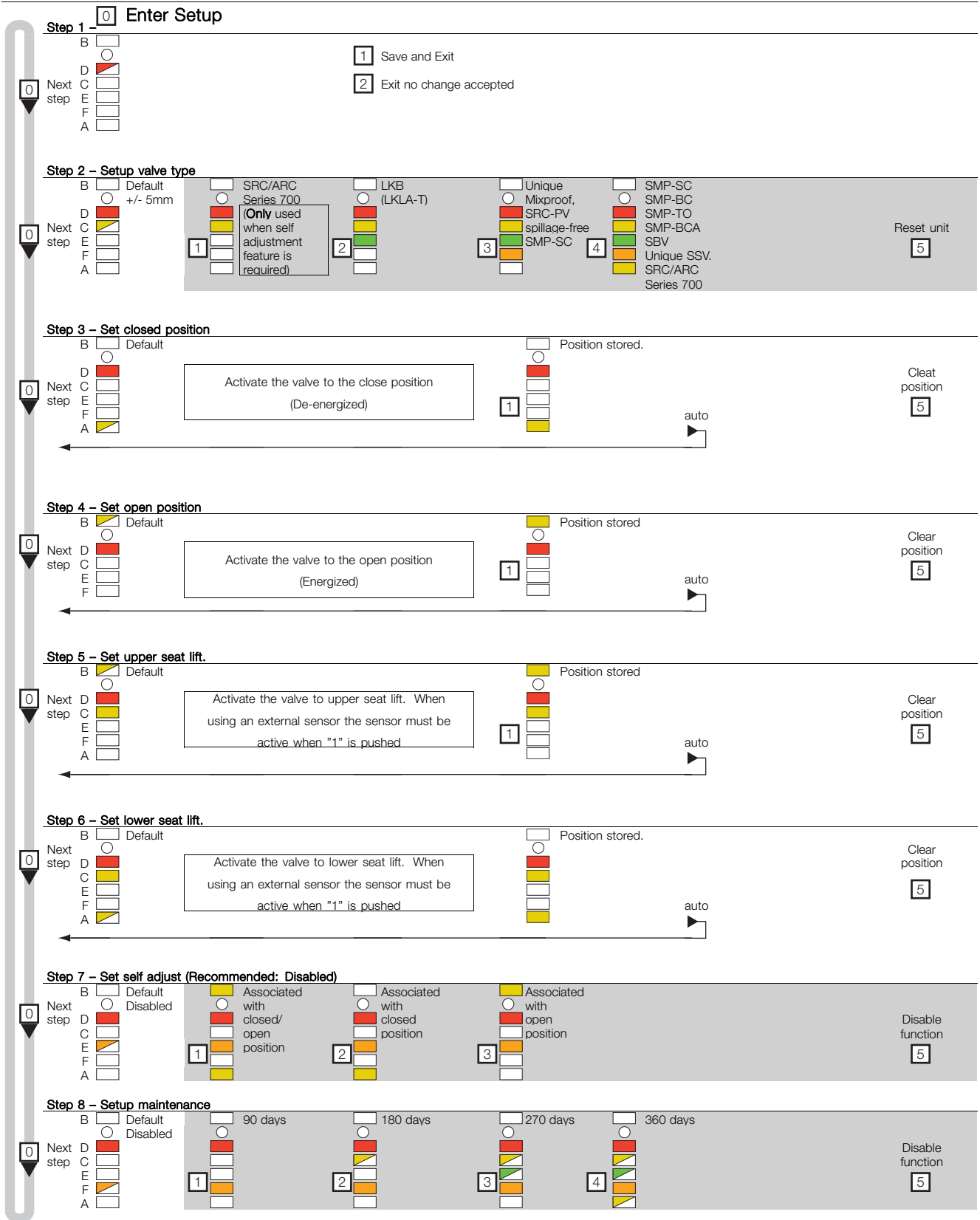

6 Setup diagram

6.2 ThinkTop setup utilising local 'I' and 'II' keys

General

Default is: Step 2, tolerance is +/- 5mm
Step 3-8, disabled

Timeout: A 60 sec. timeout is started as soon as any button(s) are released
On timeout the setup is exited with no changes saved

Flashing LED means no value set. Steady LED means value set as shown
[D] LED: Active during set-up: Flashing in step 1
Steady in all other steps

Or during operations, error condition: Steady showing hardware fault, indication pin out of range
Flashing showing software fault

General commands in each step (except step 1):

| | | |
|-----------------|-----------------------|---|
| ⓘ | Next step / skip step | (In step 3-6 the program automatically moves to the next step when a position is stored) |
| ⓘ _{5s} | Clear / disable step | (In step 2 this resets the unit to default) (The command is accepted when all unlit LED's flash briefly) |

It is recommended to reset the unit before performing a setup

Symbols

| | |
|-----------------|-------------------------|
| ⓘ | Push local key "I" |
| ⓘ | Push local key "II" |
| ⓘ _{5s} | Hold key "II" for 5 sec |

Simple representation of LED indication:

| | | | |
|-------------|---|---|--------------|
| Yellow | B | <input type="checkbox"/> | |
| IR-Receiver | | <input type="radio"/> | |
| Red | D | <input style="background-color: red;" type="checkbox"/> | Steady LED |
| Yellow | C | <input type="checkbox"/> | |
| Green | E | <input type="checkbox"/> | |
| Orange | F | <input type="checkbox"/> | |
| Yellow | A | <input style="background-color: yellow; border: 1px solid black;" type="checkbox"/> | Flashing LED |



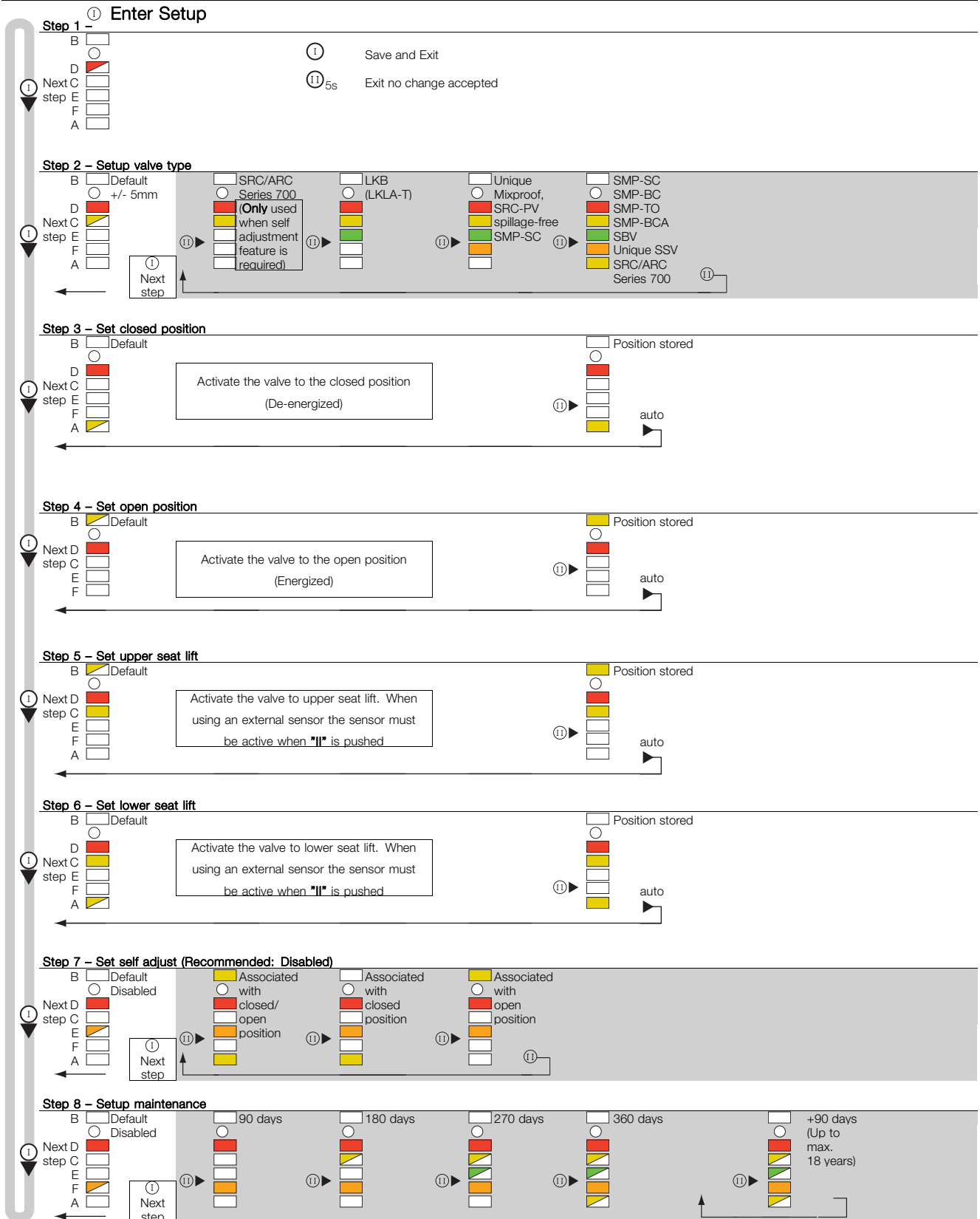

6 Setup diagram

6.3 ThinkTop quick setup guide

Valve: Unique SSV, SRC/ARC type NC (selfadjustment disabled)

| | | |
|-------|----------|--|
| Push: | | - and wait until red LED flashes |
| Push: | | |
| Push: | | - hold for 5 sec (clear all stored parameters) |
| Push: | | (red + yellow LED) |
| Push: | | (red + yellow + green LED) |
| Push: | | (red + yellow + green + orange LED) |
| Push: | | (red + yellow + green + orange + yellow LED) |
| Push: | | |
| Push: | | - to approve valve down (closed) |
| | Activate | Valve opens |
| Push: | | - to approve (open) |
| Push: | | (no upper seat-lift) |
| Push: | | (no lower seat-lift) |
| Push: | | (no self adjustment) |
| Push: | | (no maintenance) |
| Push: | | Red LED flashes (save & exit by push) |



Setup done

Valve: SRC/ARC type NO (selfadjustment enabled)

| | | |
|-------|------------|--|
| Push: | | - and wait until red LED flashes |
| Push: | | |
| Push: | | - hold for 5 sec (clear all stored parameters) |
| Push: | | (red + yellow LED) |
| Push: | | |
| | Activate | Valve closes |
| Push: | | - to approve valve closed |
| Push: | Deactivate | Valve opens |
| Push: | | - to approve valve is open |
| Push: | | (no upper seat-lift) |
| Push: | | (no lower seat-lift) |
| Push: | | = self adjustment |
| Push: | | |
| Push: | | (no maintenance) |
| Push: | | Red LED flashes (save & exit by push) |



Setup done

Valve: LKB Valve (Butterfly) NC

| | | |
|-------|----------|---|
| Push: | | - and wait until red LED flashes |
| Push: | | |
| Push: | | - hold for 5 sec |
| Push: | | (red + yellow LED) |
| Push: | | (red + yellow + green LED) |
| Push: | | |
| Push: | | - to approve valve closed (indication stem up) |
| Push: | Activate | LKB valve- open position (indication-stem down) |
| Push: | | - to approve valve is open |
| Push: | | (no upper seat-lift) |
| Push: | | (no lower seat-lift) |
| Push: | | (no self adjustment) |
| Push: | | (no maintenance) |
| Push: | | Red LED flashes (save & exit by push) |

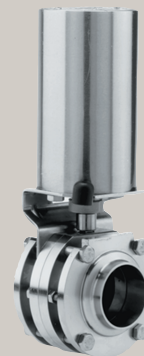

Setup done

Valve: LKB Valve (Butterfly) NO

| | | |
|-------|------------|--|
| Push: | | - and wait until red LED flashes |
| Push: | | |
| Push: | | - hold for 5 sec (clear all stored parameters) |
| Push: | | (red + yellow LED) |
| Push: | | (red + yellow + green LED) |
| Push: | | |
| Push: | Activate | - to approve valve closed (indication stem up) |
| Push: | | - to approve valve closed |
| Push: | Deactivate | LKB valve-open position (indication-stem up) |
| Push: | | - to approve valve is open |
| Push: | | (no upper seat-lift) |
| Push: | | (no lower seat-lift) |
| Push: | | (no self adjustment) |
| Push: | | (no maintenance) |
| Push: | | Red LED flashes (save & exit by push) |



Setup done

Valve: Unique mixproof Valve (with lower seat-lift)

| | | |
|-------|----------|--|
| Push: | | - and wait until red LED flashes |
| Push: | | |
| Push: | | - hold for 5 sec (clear all stored parameters) |
| Push: | | (red + yellow LED) |
| Push: | | (red + yellow + green LED) |
| Push: | | (red + yellow + green + orange LED) |
| Push: | | |
| Push: | | - to approve valve closed |
| Push: | Activate | Valve opens |
| Push: | | - to approve valve is open |
| Push: | | (no upper seat-lift) |
| Push: | Activate | Lower seat-lift active |
| Push: | | - to approve |
| Push: | | (no self adjustment) |
| Push: | | (no maintenance) |
| Push: | | Red LED flashes (save & exit by push) |





Setup done

7 Fault finding

7.1 Fault finding and LEDs

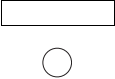
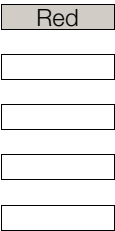
Below is stated the meaning of the LEDs' indications for fault finding in connection with the operation of the ThinkTop.

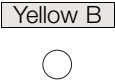
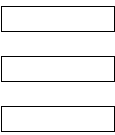
| | | |
|---|---------------|---|
|  | Red flashing: | Unit in set-up mode or internal software fault. If internal software fault, re-programme unit. |
|  | Red steady: | Unit in set-up mode or internal hardware fault. If internal hardware fault, check if magnet is in range and check correct wiring. |

| | | |
|---|---|--|
|  | 1. Orange flashing: | Time for maintenance has run out. The unit has been self-adjusted into a maintenance alert condition. Valve maintenance is strongly recommended. After maintenance: Disabling of maintenance/self-adjustment function is required before setting new position, however, it is strongly recommended to make a complete new set-up after valve maintenance. |
|  | 2. Orange steady, yellow flashing (A and/or B): | The unit has been self-adjusted into a maintenance alarm condition and the feedback is lost (a minimum of seal left). Valve maintenance is required. After maintenance: Disabling of the self-adjustment function is required before setting new position, however, it is strongly recommended to make a complete new set-up after valve maintenance. |
|  | NOTE! | The maintenance indicator lighting up, and an open or closed light flashing..... = |
|  | | Note the following: <ul style="list-style-type: none"> - Self-adjustment programme is only valid for SRC/ARC valves, do not use the programme for other valve types. - Use tolerance/valve type 1. - In conjunction with valve type change-over; 21, 22, 31 and 32, the open position must be defined as the upper sensor position (when the indication pin is in the highest position). - A loose top, indication pin or sensor system can also generate the alert/alarm condition. - Removing a ThinkTop with self-adjust activated, will immediately generate an alarm condition! If the ThinkTop has to be removed, not because of a valve maintenance issue, but for some other reasons, and you want to store the already adjusted data - disable the self-adjust function before removing the ThinkTop and enable it again once the ThinkTop is back on the actuator. - After valve maintenance a disabling of the self-adjustment function is required before setting a new position, however, it is strongly recommended to make a complete new set-up (disable all functions in step 2 valve type - and make a complete new set-up). |

| | | |
|---|----------------|----------------------------|
|  | Yellow steady: | Position A (closed valve). |
|---|----------------|----------------------------|

Yellow B Yellow steady: Position B (open valve).



Yellow steady: Position C (Seat lift 1-2 or external sensors).



Yellow C



Green Green steady: Solenoid valves energized.

Note! During set-up LED lights have different functions.

8 Maintenance

Study the instructions carefully.

Handle scrap correctly.

Always keep spare X-rings in stock.

8.1 Dismantling of ThinkTop

Step 1

1. Untighten the two Allen screws and remove the ThinkTop from the actuator.
2. Pull out X-ring (19) and replace it.

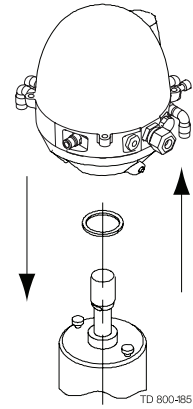

Step 2

1. Untighten the four screws.
2. Pull off cover of ThinkTop.
3. Remove X-ring (9) (grey).

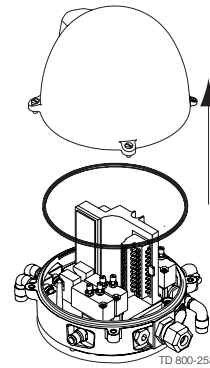

Step 3

1. Untighten screws.
2. Remove solenoid valves (up to three) and replace them with new ones.

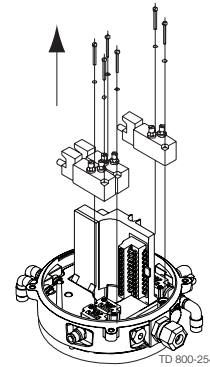

Step 4

1. To dismantle the adapter (the lower part of the ThinkTop) from base (the middle part), unscrew the three screws.
2. Turn the lower part a little clockwise and pull.
3. Replace adapter if necessary.
4. Remove the black X-ring.

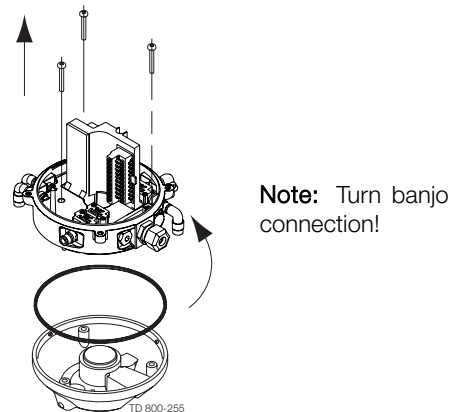

*Study the instructions carefully.
Handle scrap correctly.
Always keep spare X-rings in stock.*

Step 5

To remove the sensor unit untighten screw and pull out the sensor unit.

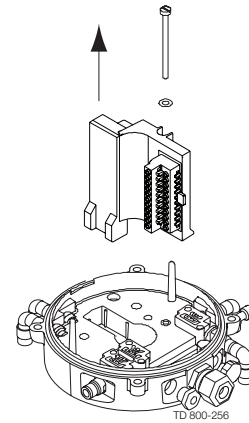

8 Maintenance

Study the instructions carefully.

Handle scrap correctly.

Always keep spare X-rings in stock.

8.2 Assembly of ThinkTop

Step 1

Place sensor unit in base and tighten screw (torque: 1 Nm).

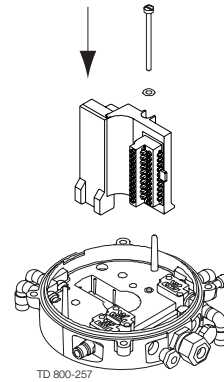

Step 2

1. Replace the black X-ring.
2. Assemble base with adapter by turning adapter slightly anticlockwise and tighten the four screws (1.9 Nm).

CAUTION!

Do NOT twist the X-ring in the groove!

The X-ring is not square; The highest (h) part must be placed as fig.

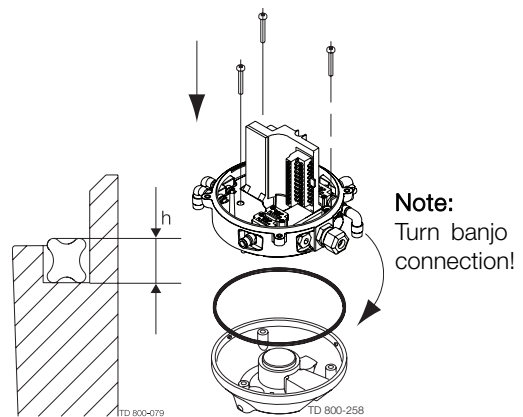

Step 3

1. Replace solenoid valves (up to three) with new ones.
2. Tighten screws (0.2 Nm).

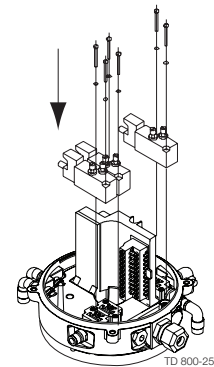

Step 4

1. Replace the grey X-ring.
2. Replace cover of ThinkTop and tighten the four screws (0.6 Nm).

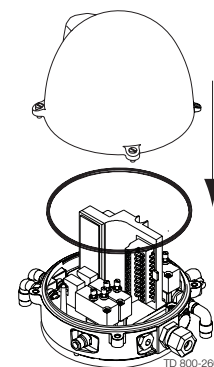

*Study the instructions carefully.
Handle scrap correctly.
Always keep spare X-rings in stock.*

Step 5

- 1. Replace the black X-ring.
- 2. Mount ThinkTop on actuator.

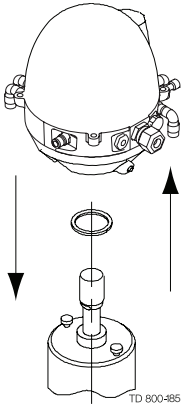

8 Maintenance

Study the instructions carefully.

Handle scrap correctly.

Always keep spare X-rings in stock.

8.3 Dismantling and assembly of Series 700 valves

Step 1

1. Remove the cover by loosening the four cover screws.
2. Separate the adapter from the base by loosening the three recess screws on top of the base.

Installation on air actuators:

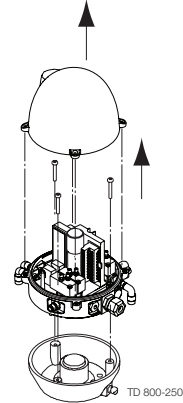

Step 2

1. Fit air fittings on actuator.
2. Position packing retainer in recess on actuator top.
3. Fit counter nut and indicator (magnet) on actuator rod. Engage approx. 1/4" thread. Tighten counter nut and indicator with two wrenches.

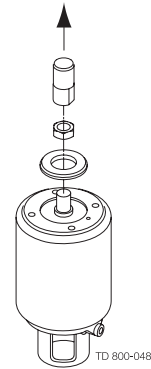

Step 3

1. Place the two O-rings in the grooves in the bottom of the adapter. Then place the adapter on the actuator top. The small O-ring must be positioned over the air hole on the actuator.
2. Fasten the adapter with the four 5/16" Allen screws.

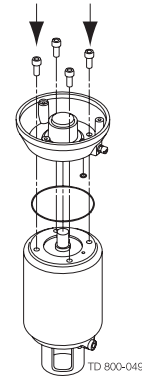

Step 4

1. Mount the base on the adapter in the position needed (can be rotated 120° in both directions). Note that one of the screw towers on the adapter has a guide recess (see * on drawing).
2. Remove x-rings (9) (grey) and (16) (black).
3. Replace with new ones.

CAUTION! Do NOT twist the X-ring in the groove! The X-ring is not square; The highest (h) part must be placed as fig.

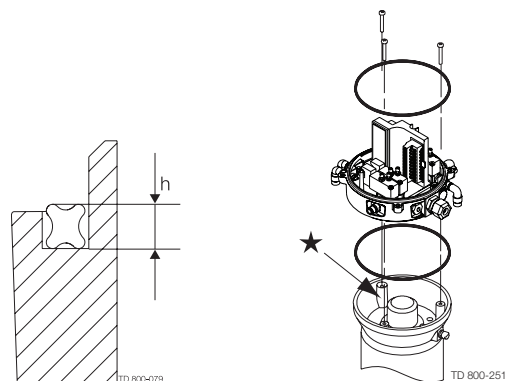

9 Parts list and Service Kits

The drawings show ThinkTop AS-Interface v.2.1 (31 nodes) & v.3.0 (62 nodes) 29.5 - 31.6 VDC.
 The items refer to the parts lists in the following sections

9.1 Drawings for ThinkTop AS-Interface

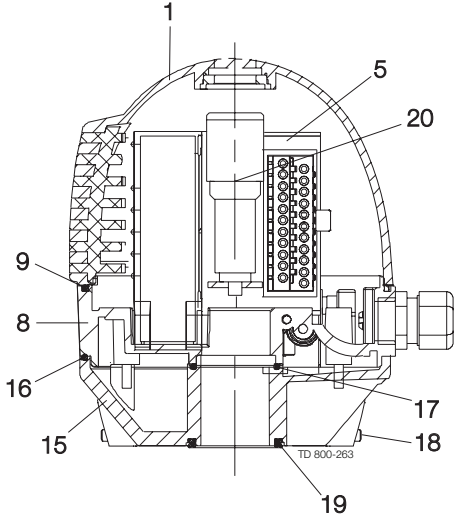
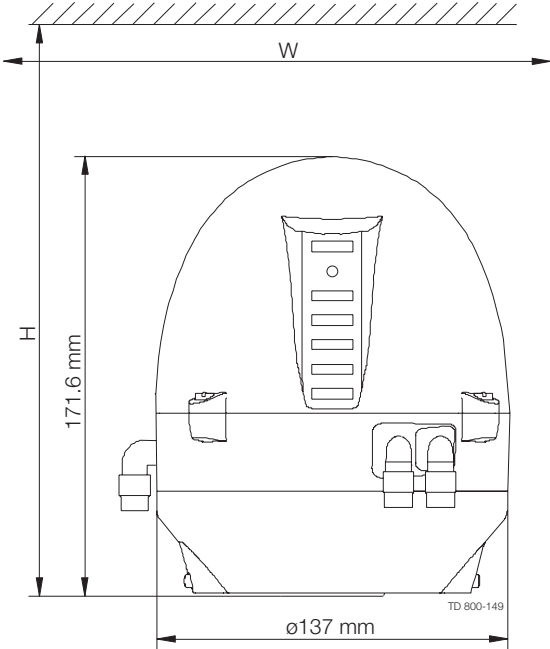

Note! This is the basic design.

| Valve Type | H | W |
|-----------------|-----|-----|
| Unique SSV NC | 225 | 250 |
| SMP-SC/-BC/-TO | 225 | 250 |
| Unique Mixproof | 225 | 250 |
| MH | 225 | 250 |
| SBV | 225 | 250 |
| Unique SSV NO | 225 | 320 |
| LKLA-T | 225 | 300 |

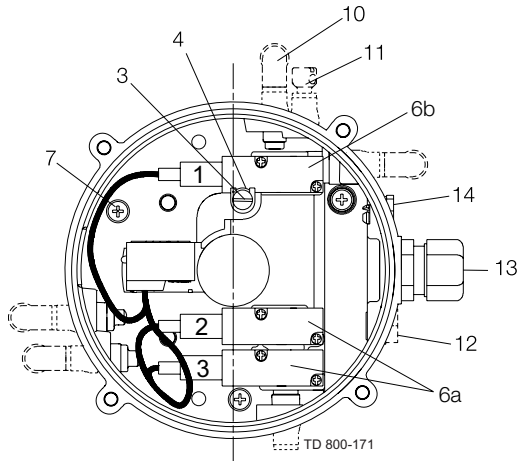

9 Parts list and Service Kits

The drawings show ThinkTop AS-Interface v.2.1 (31 nodes) & v.3.0 (62 nodes) 29.5 - 31.6 VDC.
The items refer to the parts lists in the following sections

9.2 ThinkTop AS-Interface

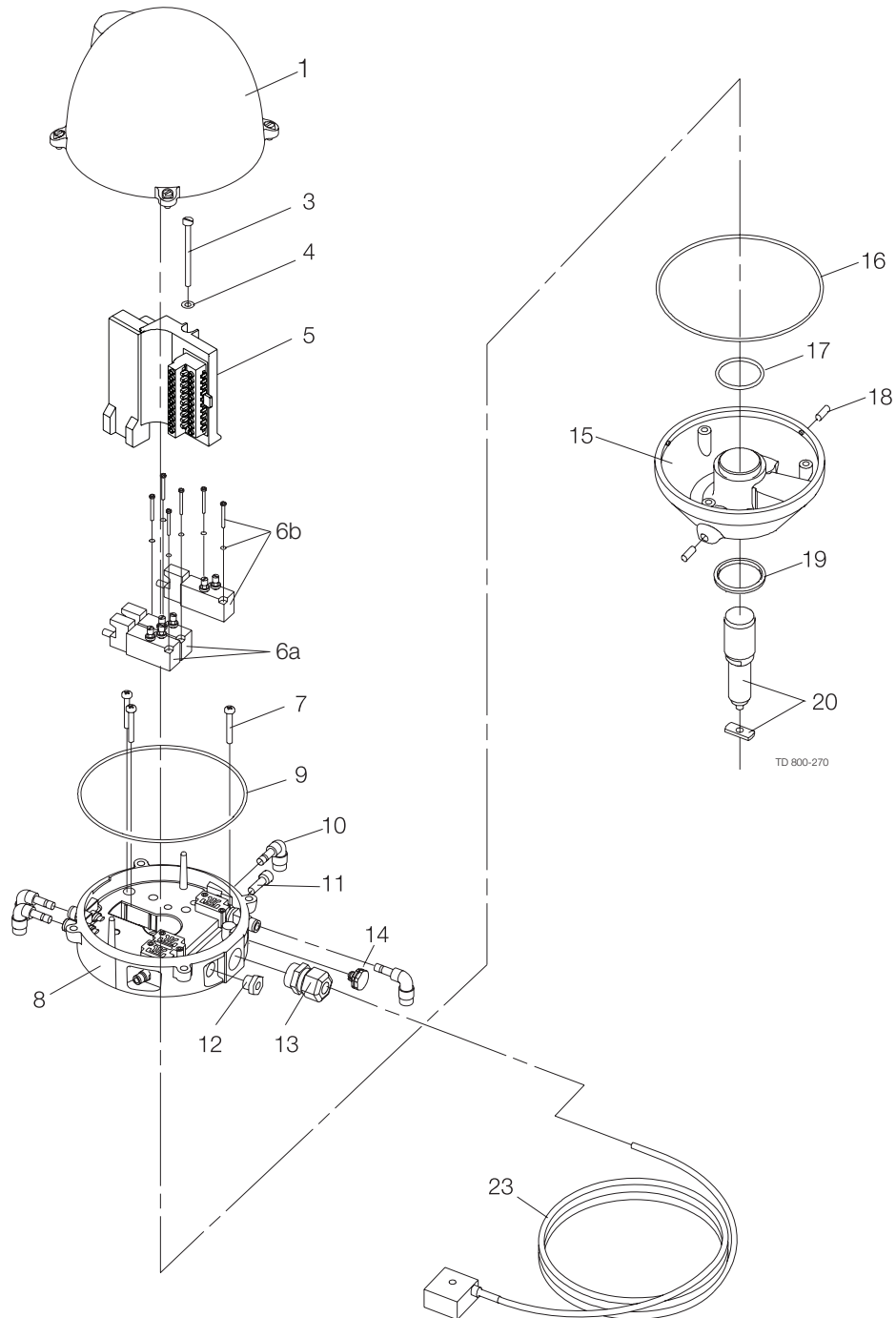

9 Parts list and Service Kits

The drawings show ThinkTop AS-Interface v.2.1 (31 nodes) & v.3.0 (62 nodes) 29.5 - 31.6 VDC.

The items refer to the parts lists in the following sections

Parts list

| Pos. | Qty | Denomination |
|------|-----|--|
| | | (Pos.9,12,13,14 included) |
| 1 | 1 | Shell complete |
| 3 | 1 | Screw |
| 4 | 1 | Washer |
| 5 | 1 | Sensor board |
| 6a | 1-2 | Solenoid valve 3/2 |
| 6b | 1 | Solenoid valve 3/2 or 5/2 |
| 7 | 3 | PT screw |
| 8 | 1 | Base |
| 9 | 1 | Special X-ring, grey |
| 10 | 1 | Air fitting |
| 11 | 1 | Blow-off valve |
| 12 | 1 | Thread plug, PG7 ø3-ø6.5 mm |
| 13 | 1 | Cable gland, PG11 ø4-ø10 mm |
| 14 | 1 | Gore vent High airflow |
| 15 | 1 | Adapter complete |
| 16 | 1 | Special X-ring, black |
| 17 | 1 | O-ring |
| 18 | 2 | Allen screw |
| 19 | 1 | Special X-ring |
| 20 | 1 | Indication pin |
| 23 | 1 | 2 m ASI drop cable (2 x 0.5 mm ²) with flat cable connector |

Service kits

| | |
|---|--------------|
| Solenoid valve 3/2, 24 VDC | 9611-99-3324 |
| Solenoid valve 5/2, 24 VDC | 9611-99-3327 |
| Indication pin | 9612-5623-01 |
| Special indication pin, SRC-LS | 9612-6370-01 |
| Special indication pin, Unique SSV-LS | 9613-1581-01 |
| Special indication pin, Unique SSV High Pressure | 9613-1581-01 |
| Air fitting, Ø6 mm | 9611-99-3405 |
| Air fitting, 1/4" | 9611-99-3433 |
| Gore vent | 9611-99-4722 |
| X-ring, pos. 9 | 9613-4564-01 |
| X-ring, pos. 16 | 9612-9994-01 |
| X-ring, pos. 19 | 9612-5696-01 |
| Sensor board AS-Interface 29.5-31.6 VDC (Period -0902 | 9612-5627-03 |
| Sensor board AS-Interface v.2.1 (31 nodes) (Period 0902-) .. | 9613-4434-02 |
| Sensor board AS-Interface v.3.0 (62 nodes) (Period 0902-) .. | 9613-4434-03 |

TD 900-389/3

9 Parts list and Service Kits

The drawings show ThinkTop AS-Interface v.2.1 (31 nodes) & v.3.0 (62 nodes) 29.5 - 31.6 VDC Series 700 valves.
 The items refer to the parts lists in the following sections

9.3 Drawings for ThinkTop AS-Interface for Series 700

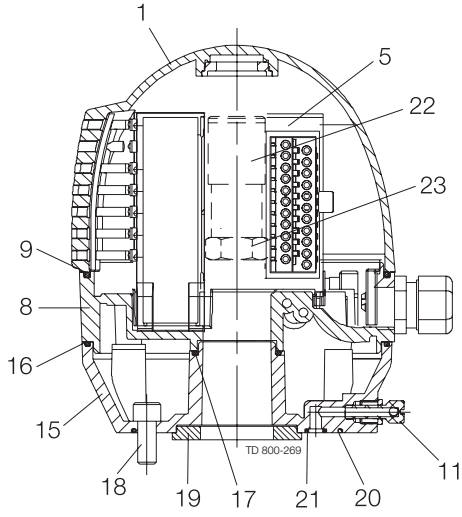
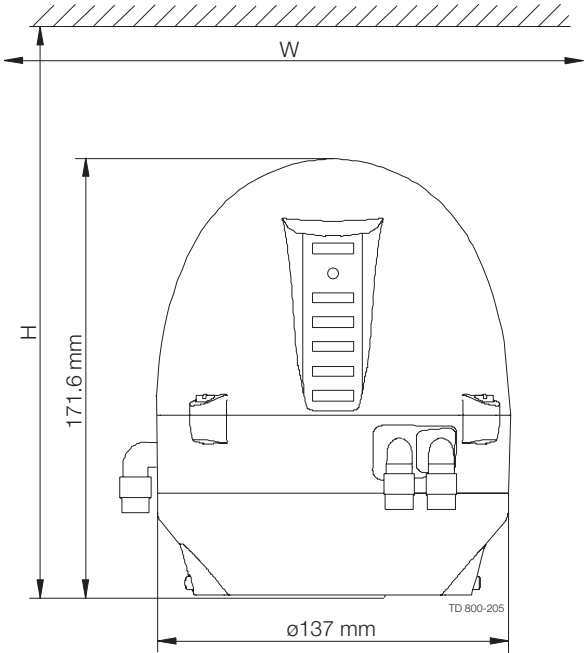

Note! This is the basic design.

| Valve Type | H | W |
|-----------------|-----|-----|
| Unique SSV NC | 225 | 250 |
| SMP-SC/-BC/-TO | 225 | 250 |
| Unique Mixproof | 225 | 250 |
| MH | 225 | 250 |
| SBV | 225 | 250 |
| Unique SSV NO | 225 | 320 |
| LKLA-T | 225 | 300 |

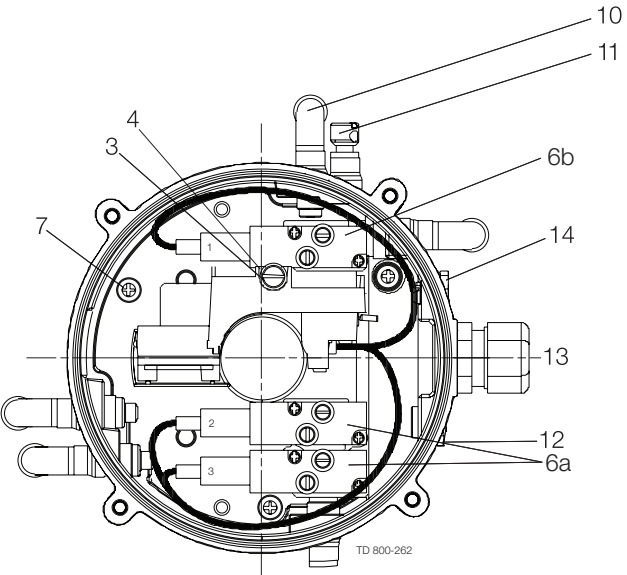

9 Parts list and Service Kits

The drawings show ThinkTop AS-Interface v.2.1 (31 nodes) & v.3.0 (62 nodes) 29.5 - 31.6 VDC Series 700 valves.
The items refer to the parts lists in the following sections

9.4 ThinkTop AS-Interface for Series 700

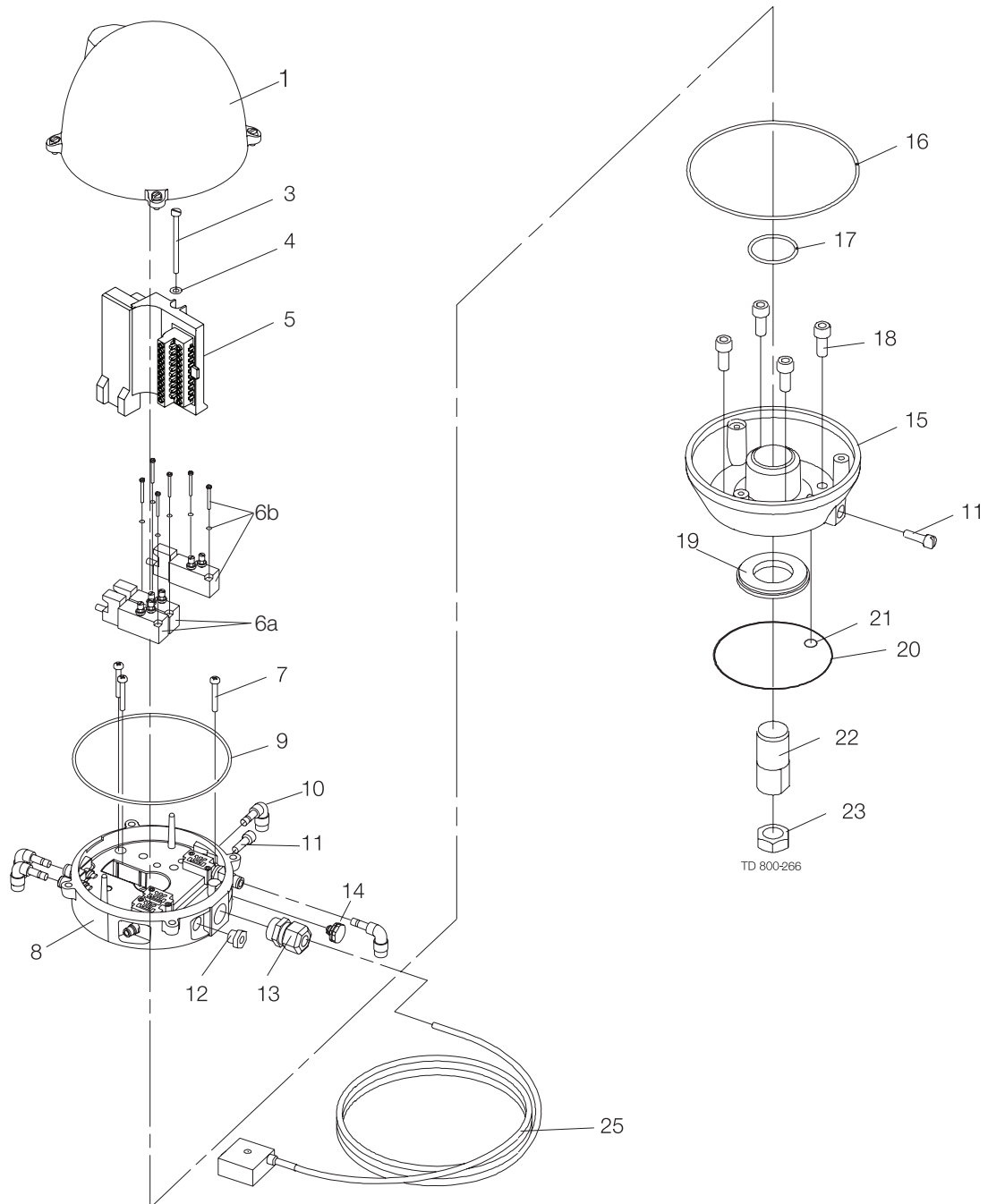

9 Parts list and Service Kits

The drawings show ThinkTop AS-Interface v.2.1 (31 nodes) & v.3.0 (62 nodes) 29.5 - 31.6 VDC Series 700 valves.
The items refer to the parts lists in the following sections

Parts list

| Pos. | Qty | Denomination |
|------|-----|--|
| | | (Pos.9,12,13,14 included) |
| 1 | 1 | Shell complete |
| 3 | 1 | Screw |
| 4 | 1 | Washer |
| 5 | 1 | Sensor board |
| 6a | 1-2 | Solenoid valve 3/2 |
| 6b | 1 | Solenoid valve 3/2 or 5/2 |
| 7 | 3 | PT screw |
| 8 | 1 | Base |
| 9 | 1 | Special X-ring, grey |
| 10 | 1 | Air fitting |
| 11 | 2 | Blow-off valve |
| 12 | 1 | Thread plug, PG7 ø3-ø6.5 mm |
| 13 | 1 | Cable gland, PG11 ø4-ø10 mm |
| 14 | 1 | Gore vent High airflow |
| 15 | 1 | Adapter complete |
| 16 | 1 | Special X-ring, black |
| 17 | 1 | O-ring |
| 18 | 4 | Screw |
| 19 | 1 | Retainer |
| 20 | 1 | O-ring |
| 21 | 1 | O-ring |
| 22 | 1 | Indicator pin |
| 23 | 1 | Nut |
| 25 | 1 | 2 m ASI drop cable (2 x 0.5 mm ²) with flat cable connector |

Service kits

| | |
|---|--------------|
| Solenoid valve 3/2, 24 VDC | 9611-99-3324 |
| Solenoid valve 5/2, 24 VDC | 9611-99-3327 |
| Indication pin | 9612-6357-02 |
| Air fitting, 1/4" | 9611-99-3433 |
| Gore vent | 9611-99-4722 |
| X-ring, pos. 9 | 9613-4564-01 |
| X-ring, pos. 16 | 9612-9994-01 |
| Sensor board AS-Interface 29.5-31.6 VDC (Period -0902 | 9612-5627-03 |
| Sensor board AS-Interface v.2.1 (31 nodes) (Period 0902-) .. | 9613-4434-02 |
| Sensor board AS-Interface v.3.0 (62 nodes) (Period 0902-) .. | 9613-4434-03 |

How to contact Alfa Laval

Contact details for all countries are continually updated on our website.

Please visit www.alfalaval.com to access the information directly.

© Alfa Laval Corporate AB

This document and its contents is owned by Alfa Laval Corporate AB and protected by laws governing intellectual property and thereto related rights. It is the responsibility of the user of this document to comply with all applicable intellectual property laws. Without limiting any rights related to this document, no part of this document may be copied, reproduced or transmitted in any form or by any means (electronic, mechanical, photocopying, recording, or otherwise), or for any purpose, without the expressed permission of Alfa Laval Corporate AB. Alfa Laval Corporate AB will enforce its rights related to this document to the fullest extent of the law, including the seeking of criminal prosecution.